



HARDI KENYA
CROP SPRAYING SPECIALISTS



**PRODUCT
CATALOGUE**
2023

TABLE OF CONTENTS



2. Introduction	
3. Partners	
4. Table of contents	
5. Hand held Sprayers Knapsacks Trolley sprayers Tractor mounted sprayers Central spray unit Hockey Stick boom	
6. Pumps Hardi pumps COMET pumps AR pumps	
7. COMET Regulators	
8. Lances Watering lances Connectors and fittings Verticle boom	
9. Hose pipes	
10. Fittings	
11. Personal Protective Equipment	
12. Trimble	
13. Swingtec	
14. Jiffy	



HARDI KENYA is now East Africa's largest supplier of Application Technology Equipment into all sectors of Agriculture, from cereal growers to vegetable and flower farms.

As the sole representatives of **HARDI INTERNATIONAL A/S** in East Africa, we supply and support all HARDI Farm Sprayers, from Knapsack sprayers to Self-Propelled Units. In addition, HARDI KENYA represents a number of other major suppliers to agriculture, horticulture and floriculture, including COMET high pressure spraying pumps, TRIMBLE Agricultural Guidance and Control Systems, JIFFY Plant Propagation Products and UFO Supplies.

As suppliers of high quality spraying equipment, we also stock a complete range of Personal Protective Products that are fully certified.

HARDI KENYA continues to develop innovative designs for all aspects of Application Technology, suited specifically to the East African agricultural, floricultural and horticultural sectors.



We represent the following renowned international brands.



HARDI INTERNATIONAL A/S

Manufacturers of the highest quality crop spraying machinery, including sprayers from 1.5litre compression Garden Sprayers to 8,000litre Self-Propelled units with 39m booms.



COMET

Comet is an Italian manufacturer specializing in production of low, medium and high pressure diaphragm, piston and centrifugal agricultural and industrial pumps which are world renowned for their performance and reliability.



COOPER PEGLER / HOZELOCK

The CP3 and CP15 Knapsack Sprayers have been recognised as the most reliable and well built hand-operated sprayers for decades, and Hozelock Hoses, which are now part of the same Group, produce comparably high quality watering hose.



ANNOVI REVERBERI

Hardi Kenya has long had a relationship with AR, and has used their High Pressure pumps on their hose Reel and Central Spraying Units since the 1980s. Hardi Kenya continues to fit and support all AR pump models used in East Africa.



UFO SUPPLIES

Specialists in supplying the floriculture and horticultural sectors in Africa and beyond with a variety of equipment from PPE to Defoliators, UFO Supplies has had a firm relationship with Hardi Kenya since their inception.



SWINGTEC

As manufacturers of Fogging Machines, including the world-renowned Swingfog fogger, Swingtec are experts in the production of Ultra-low volume spraying equipment.



JIFFY INTERNATIONAL

Jiffy Planting Substate products are innovative and assist farmers at the very start of the planting process, ensuring the lowest possible seedling and cutting loss through consistent quality and minimizing replanting stress.

HAND HELD SPRAYERS



KNAPSACKS

Safety & Comfort

The HARDI 20 and 15 litre Backpack Sprayers feature a leak proof tank design with a piston pump for easy cleaning and maintenance.

- With pressure up to 3 bar they are ideal for insecticides, fungicides and herbicides.
- High safety standards and comfort are achieved through advanced sprayer design.
- Long sprayer life is assured through the use of robust materials.
- Service, spares and accessories all available through Hardi Kenya Ltd.



COMPRESSION SPRAYERS

P1.5, P6 & P8

HARDI P1.5, P6 and P8 handheld pressure sprayers are perfect for professional and residential plant care in small areas. They are easy to use, sturdy and built to last. Available in 3 compact sizes: 1.5, 6 or 8 litres.



P8

P6

P 1.5

KNAPSACKS



The CP range of Diaphragm pumps have been used for decades. They have proved to be the most durable, robust and accurate sprayers well suited for pesticide and herbicide applications under the harshest of conditions.

- The unique pump, combined with a pressure relief valve, tolerates abrasive particles like wettable powders and dirty water. There are no direct friction surfaces, so it is also easy to pump.
- The CP is simple to use, the spray tank is not pressurised, and spraying is controlled from the trigger valve. The spray lance is made of extremely strong carbon fibre making it almost unbreakable.



MOTORIZED KNAPSACK SPRAYERS

HOZELOCK Electric Sprayer

Get a constant spray at the touch of a button with the Hozelock Pulsar Sprayer. No pumping required. This new 15L knapsack sprayer has an 18v lithium-ion battery that provides enough power to spray upto 4 hours, dependending on the pressure used. There are three levels of pressure to suit all applications. 1 bar, 3 bar and one position for high flow.



MISTBLOWER

"The BPM 100 is a 16 litre backpack mistblower used for low volume application of pesticides over large areas where there might be limited access or where canopy penetration is required.

A motorised centrifugal fan produces high air speed through a venturi air outlet which shears the spray liquid into a fine mist. The mist is carried to the target in the air stream which is directed by the operator. The spraying range for the BPM100 Mistblower is 15m horizontally or 12m vertically. A needle valve provides flow rate control and multi-function controls handle stop start, an speed and fluid flow rate."



SPRAYING PUMPS



To meet the requirements of bigger sprayers and to improve the lifetime, Hardi has redesigned their pumps.



HARDI PUMP 364/464

General specifications:

- Six diaphragm Positive Displacement Pump
- 6-Splined 1 3/8" Shaft
- Normal Rotational Speed - 540rpm
- Maximum Pressure - 15bar
- Flow rate @ 540rpm - 150l/min (364) or 200l/min (464)



HARDI PUMP 1303

General specifications:

- Three diaphragm Positive Displacement Pump
- Tapered Shaft for use with HARDI PTO Shaft
- Normal Rotational Speed - 540rpm
- Maximum Pressure - 15bar
- Flow rate @ 540rpm - 98l/min

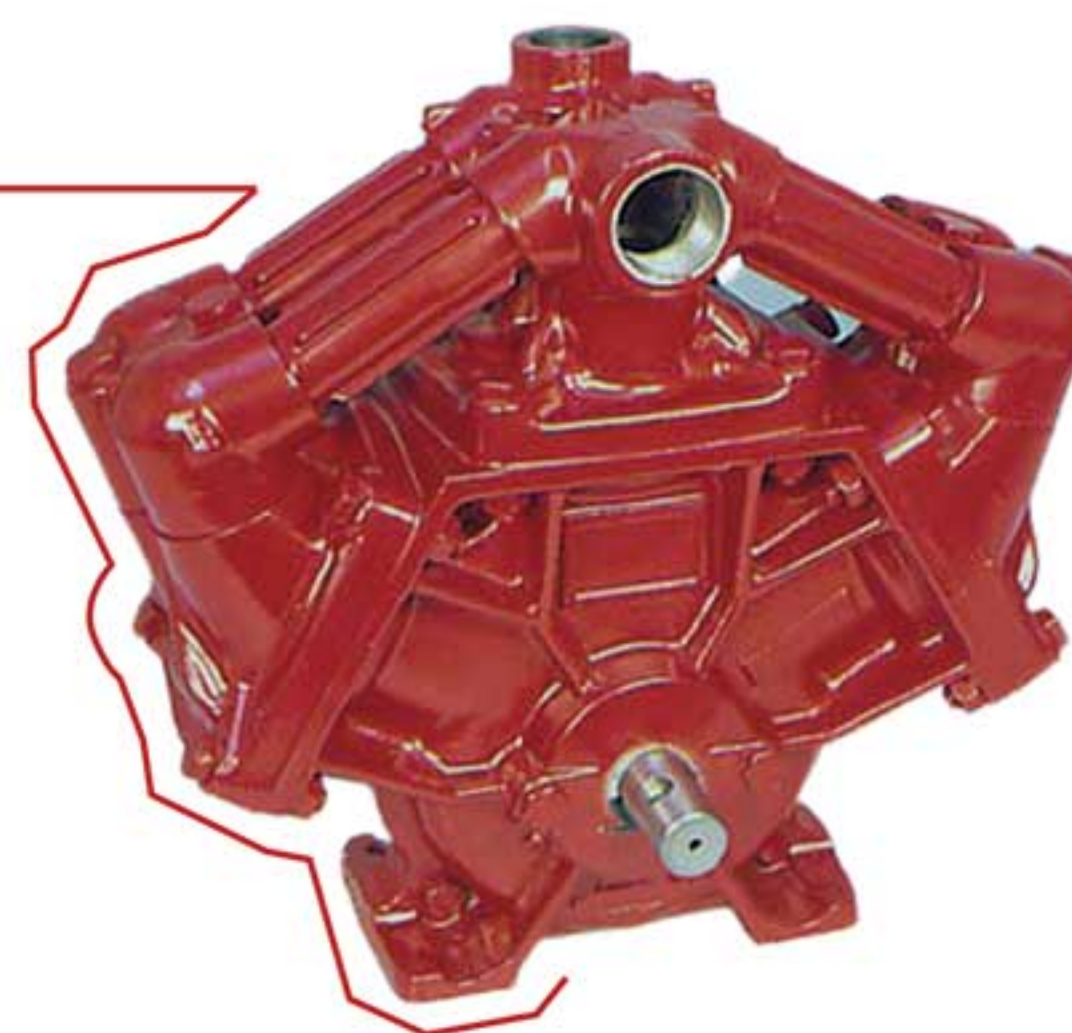

HARDI PUMP 1203

General specifications:

- Three diaphragm Positive Displacement Pump
- Tapered Shaft for use with HARDI PTO Shaft
- Normal Rotational Speed - 540rpm
- Maximum Pressure - 15bar
- Flow rate @ 540rpm - 67l/min

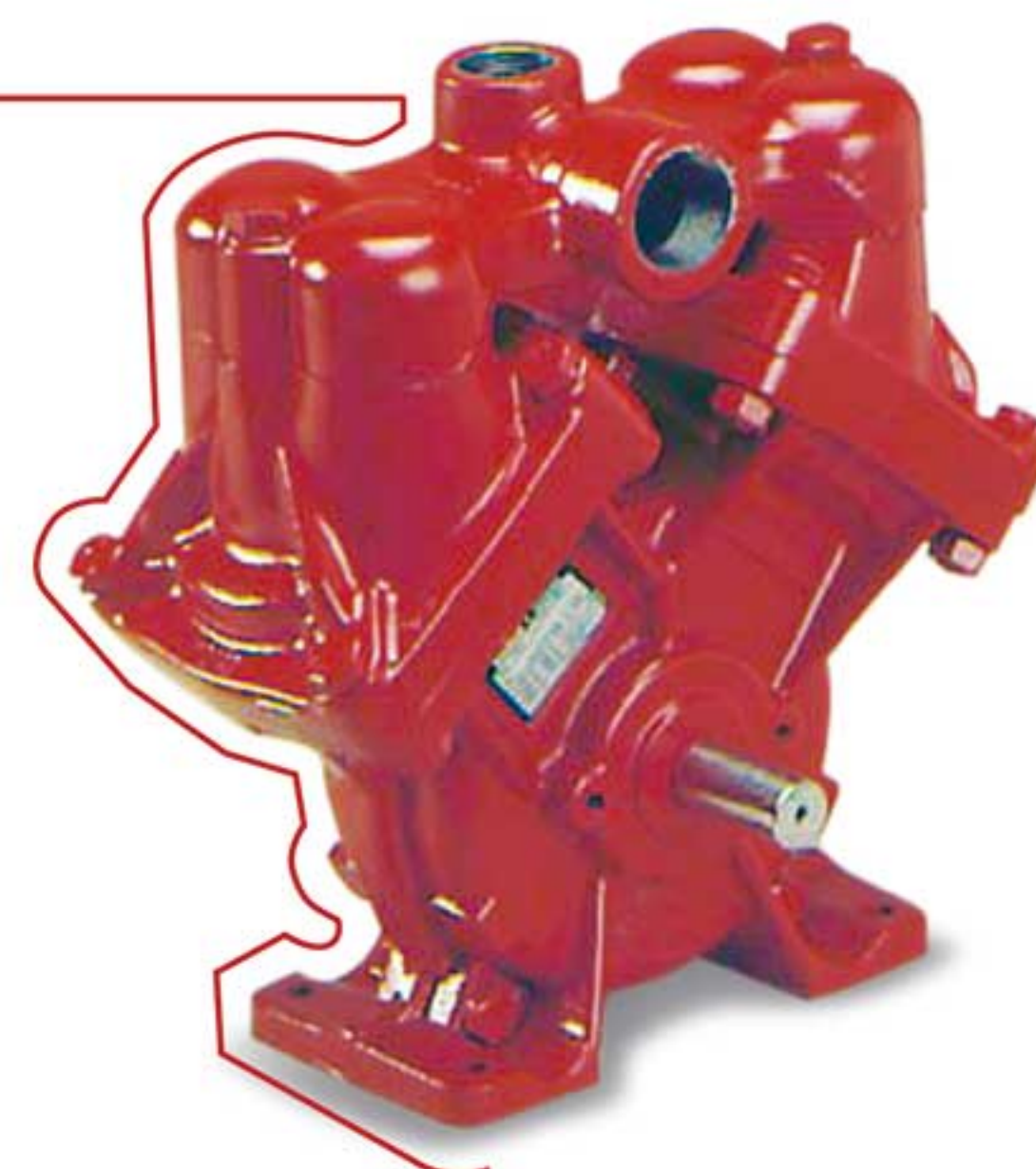



Comet diaphragm pumps are synonymous with quality and innovation. Recognized all over the world, Comet diaphragm pumps are ideal for high pressure applications in green houses, nurseries and orchards.

COMET AP41

General specifications:

- Semi-hydraulic, three diaphragm pump
- Pressure and flow specification: 40 bar - 38 l/min
- Internally manifolded
- Anodized aluminum construction for corrosion resistance
- Connects to shafts, fan assemblies, pulleys, and gearboxes
- Self-priming, large capacity oil bath crankcase, mounting rails, and can be run dry
- Operates maximum of 550 rpm and 4.1 hp.



COMET APS61

General specifications:

- Semi-hydraulic, three diaphragm pump
- Pressure and flow specification: 50 bar - 62 l/min
- Internally manifolded and features anodized aluminum
- Construction for corrosion resistance
- Connects to shafts, fan assemblies, pulleys & gearboxes
- Compatible pumping chemicals such as herbicides, pesticides, and others
- Self-priming, large capacity oil bath crankcase, mounting rails with standard pattern
- Operates at a maximum of 550 rpm and 9.1 hp.



COMET APS96

General specifications:

- Semi-hydraulic, four diaphragm pump
- Pressure and flow specification: 50 bar - 88 l/min
- Internally manifolded and features anodized
- Aluminum construction for corrosion resistance
- Easily connects to shafts, fan assemblies, pulleys, and gearboxes
- Operates at a maximum of 550 rpm and 11.7 hp.

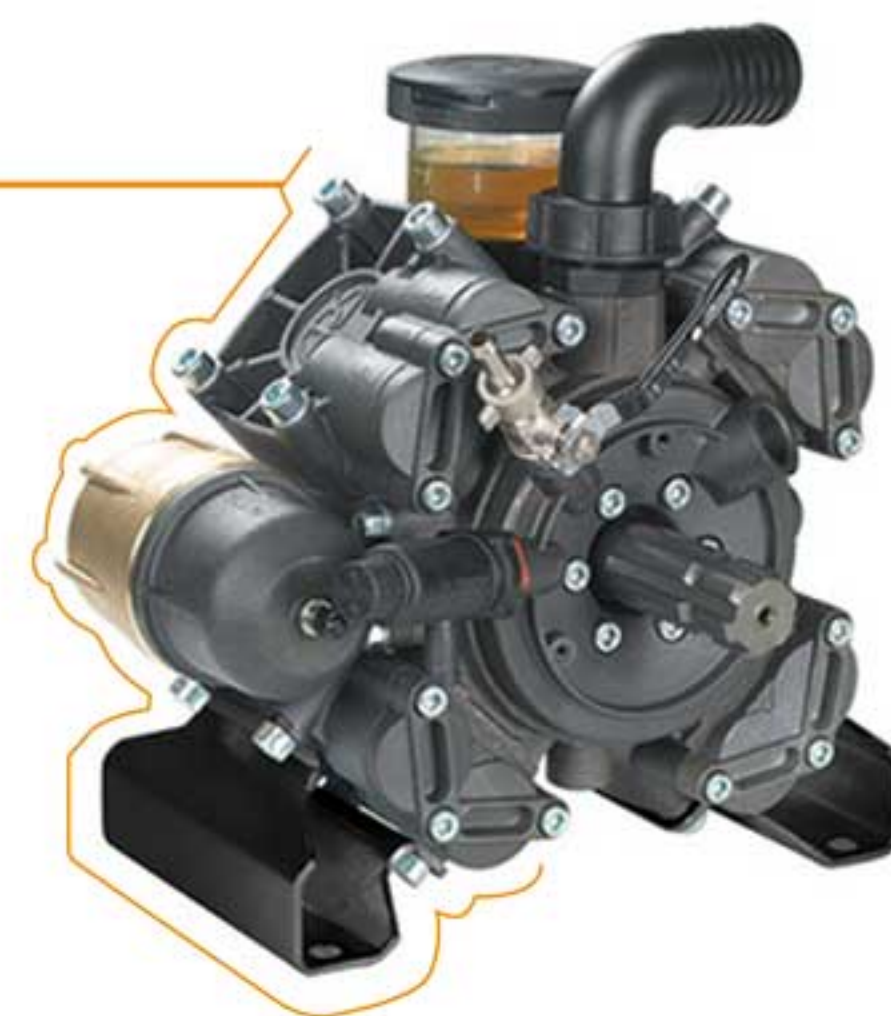

COMET IDS960

General specifications:

- Semi-hydraulic, four diaphragm pump
- Maximum outputs rated 50 bar and 93 l/min
- Manifolds to provide corrosion resistance
- Features brass heads and brass external manifolds
- Perfect for high pressure agricultural and horticultural applications such as orchards, vegetables, trees, vineyard spraying, and more
- Easily connects to tractor ptos with the 6 spline, PTO shaft (1 3/8") setup
- Self-priming, large capacity oil bath crankcase, mounting rails and can be run dry
- Operates at maximum of 550 rpms and 11.5 hp.



COMET IDS1000

General specifications:

- Semi-hydraulic, three diaphragm pump
- Maximum outputs rated 50 bar and 99 l/min
- Features brass heads and brass external manifolds to provide corrosion resistance
- Perfect for high pressure agricultural and horticultural applications such as orchards, vegetables, tress, vineyards, and more
- Connects to tractor ptos with the 6 spline PTO shaft (1 3/8") setup
- Features a 1" by-pass, self-priming, large capacity oil bath
- Crankcase, pressure accumulator, safety valve mounting rails with standard pattern
- Operates at maximum of 550 rpms and 12.5 hp.

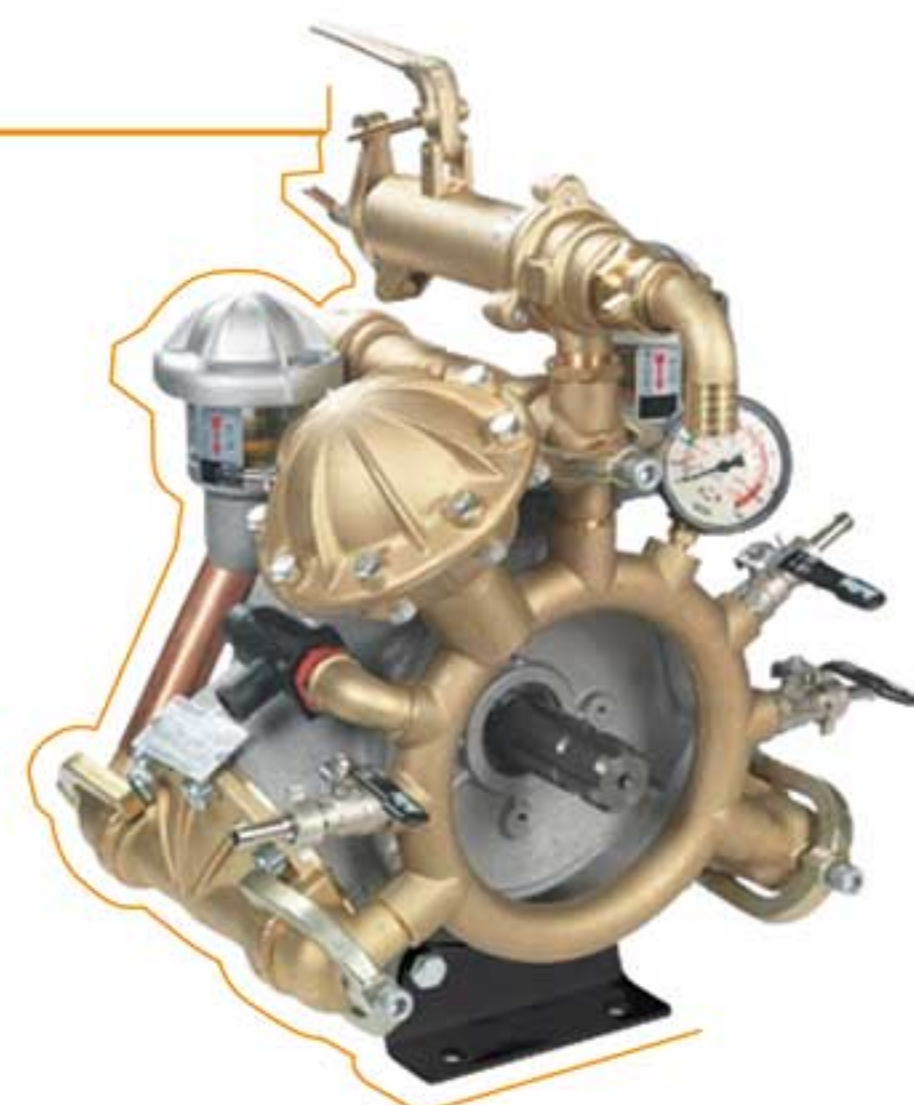

COMET YA75

General specifications:

- Configuration: 3 ceramic plungers
- Parts in contact with spray liquid: anodized aluminium
- Maximum outputs rated 50 bar and 58 l/min
- Double seal with drip recovery
- Patented piston oil guard anti-wear system.



COMET YA 130

General specifications:

- Configuration: 6 ceramic plungers
- Parts in contact with spray liquid: anodized aluminium
- Maximum outputs rated 50 bar and 128 l/min
- Double seal with drip recovery ● Patented piston oil guard anti-wear system.

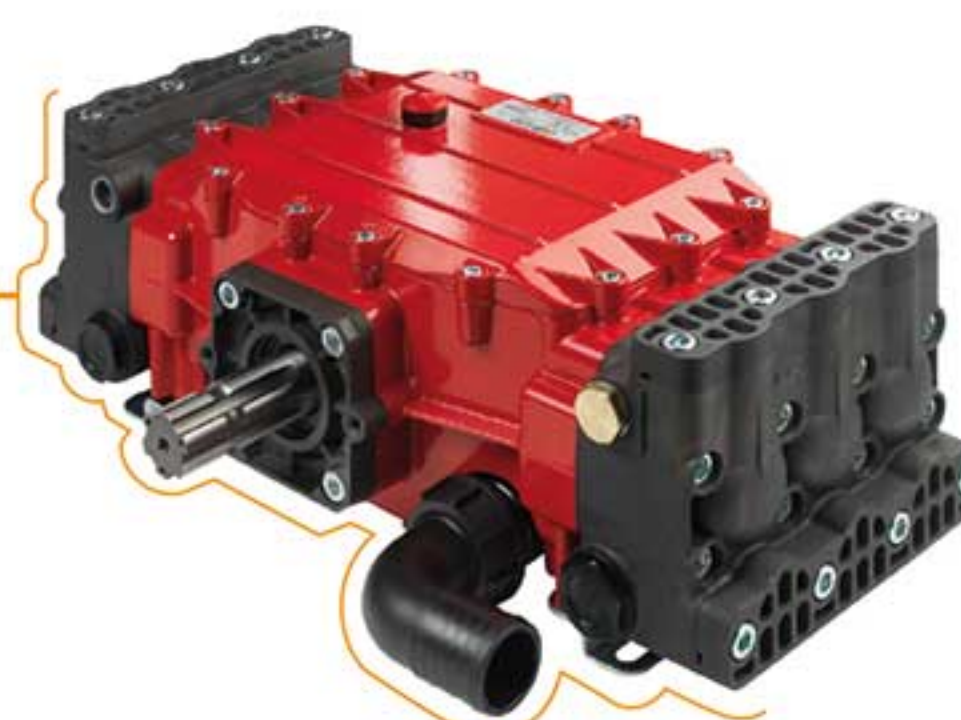



COMET BP 60 K

General specifications:

- Two Diaphragm pump
- Ideal for use with small Boom Sprayers
- Maximum outputs rated at 20 bar and 65l/min
- Parts in contact with spray liquid are plastic-coated aluminium
- Come standard with Pressure Accumulator
- Operates at a maximum of 550rpm



COMET BP 110 SMART

General specifications:

- Three Diaphragm pump
- Perfect for use with lift-mounted and trailed Boom Sprayers
- Maximum outputs rated at 20 bar and 132l/min
- Parts in contact with spray liquid are polyamide
- Pressure Accumulator fitted on request.
- Operates at a maximum of 550rpm





AR1064

General specifications:

- Max flow: 108.5 L/min
- Max pressure: 50 bar
- Shaft: Flange for pulley and 1-3/8" 6-spline male PTO 1-1/2" inlet, 3/4" outlet
- Diaphragms: 4, semi-hydraulic, BlueFlex® material
- Housing: Anodized aluminum
- Recommended control unit: VDR50.



AR1604

General specifications:

- Max flow: 153 L/min
- Max pressure: 50 bar
- Shaft: Flange for pulley and 1-3/8" 6-spline male PTO 1-1/2" let, 3/4" outlet
- Diaphragms: 4, semi-hydraulic, BlueFlex® material
- Housing: Anodized aluminum
- Recommended control unit: VDR50.

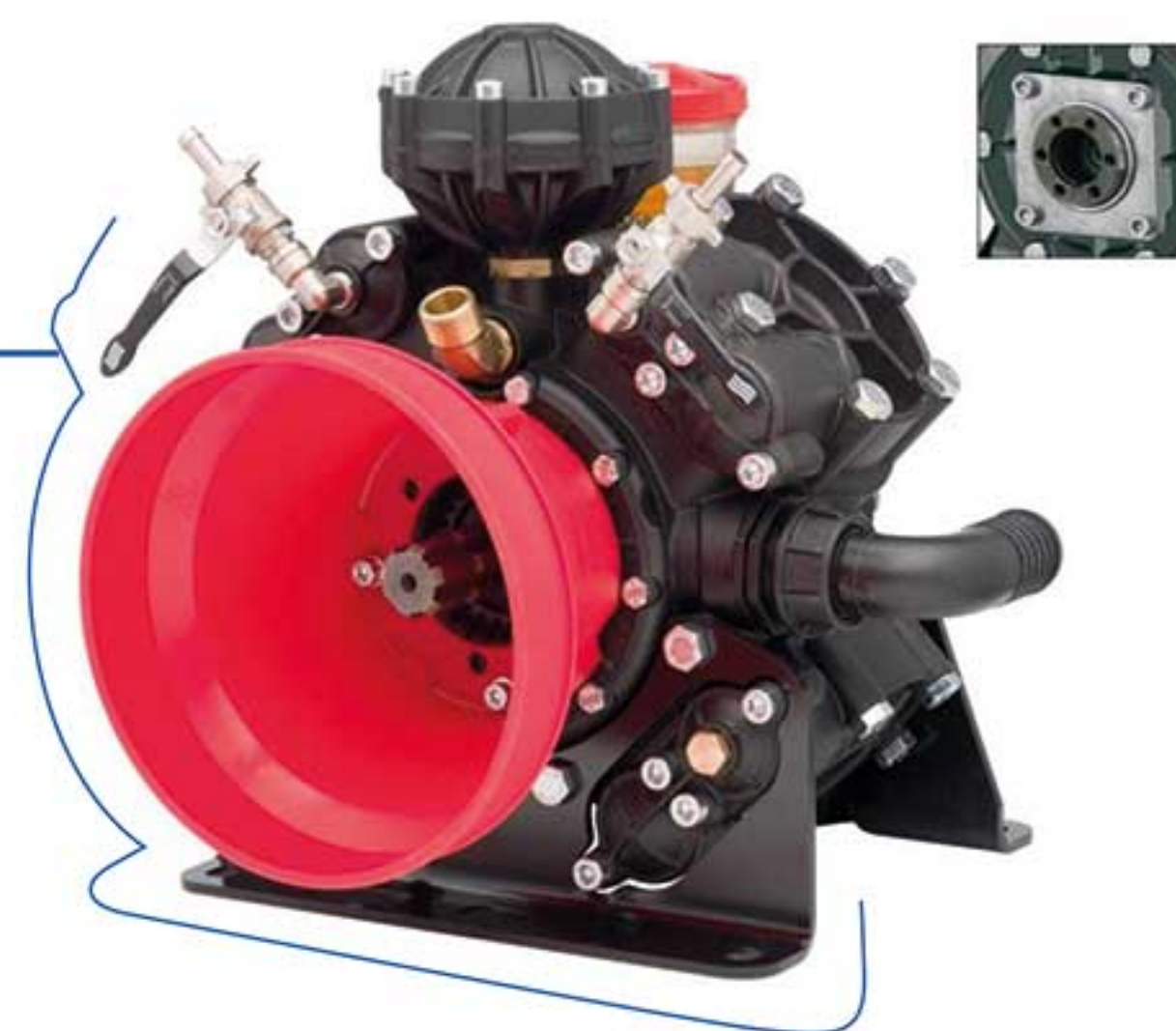

PRESSURE REGULATORS/ OPERATING UNITS



COMET GEMINI

General specifications:

- To be fitted to lower-flow High Pressure Pumps
- Maximum flow rate: 50l/min @ 40bar
- Constant Pressure Regulation Valve
- Single Shut-off Lever
- 2 outlets



COMET GCP 3V

General specifications:

- To be fitted to medium-flow High Pressure Pumps
- Maximum flow rate: 100l/min @ 50bar
- Constant Pressure Regulation Valve
- Single Shut-off Lever
- 3 outlets



COMET HPR/2

General specifications:

- To be fitted to high-flow High Pressure Pumps
- Maximum flow rate: 150l/min @ 50bar
- Constant Pressure Regulation Valve
- Single main Shut-off Lever
- Anti drip suck-back device
- Made of anti-corrosion anodised aluminium
- 3 outlets





**ANNOVI
REVERBERI**
The Power of Experience

CONTROL UNIT VDR 50

Features:

- For working pressure up to 50 bar and flow 130 l/min
- 2 Outlets
- Made of anodised aluminium.



CONTROL UNIT BY MATIC

Features:

- For working pressure up to 50 bar and flow 200 l/min
- 2 Outlets
- Made of anodised aluminium.



COMPLETE SPRAYING UNITS





WHEELBARROW AND TROLLEY SPRAYERS

Hardi Kenya's 120 litre wheel barrow sprayer and 200, 300, 400 and 600 litre Trolley Sprayers are purpose-built to provide versatility and convenience in a range of applications, including greenhouse crops and outdoor horticulture.

The TR200, TR300 and TR 400 are mounted on 3 pneumatic tyres, the front one a Low Ground-force Floation tyre while the TR400 and TR600 utilizes 4 13" pneumatic tyres.

The TR Trolley's frame is specially designed for its strength and manoeuvrability, and has UV resistant polyethylene tank, with a large filling aperture and filter.



Hoses: Rubber/ PVC
80 Bar working pressure/ 200 Bar bursting pressure



Pump: Comet APS41 3-diaphragm
Flow Rate: 40 Litres/ minute | Max. Pressure: 40 Bar

Engine: Briggs & Stratton Vanguard / Honda GX200
Petrol 4-stroke | Power Output: 6.5 HP | Engine Speed: 3000rpm

Tank:
200/ 300/ 400/ 600
Litres HDPE





TRAILED HOSE REEL SPRAYERS

Hardi Kenya's design of its Trailed Hose Reel Sprayer stretches back to the beginnings of Kenya's Horticultural journey. The requirement of the early farmers for a robust, easy-to-use sprayer for use on vegetable and fruit farms led to the development of the sprayer still available today.

The use of the strong 400/600 litre NK tank and frame, the addition of a COMET/AR high pressure pump and a variety of high pressure hose and reel options make it a highly versatile sprayer.





TRACTOR MOUNTED HOSE REEL SPRAYERS

Hardi Kenya's 400 and 600 litre Tractor-Mounted Sprayers can be fitted with up to 4 hose reels. They have been adapted from Hardi's well known NK boom sprayer, and have a high quality, blow-moulded, UV-resistant HDPE tank, fitted with a large tank lid and a deep sump.



The Hose Reel sprayer can be fitted with a range of high pressure COMET or AR pumps to suit the customer's needs, and a Pressure Regulator to suit the specific pump.

High Pressure (80/200bar) Delivery hoses can be lengths that suit the application, and both Rubber (10mm) and PVC (8 or 10mm) types are available.

Specially made Stuffing Boxes are fitted to the hose reels to prevent twisting when loading/unloading the hose. This allows hoses to be used even when the complete length of hose is not required, and protects the hoses from kinks caused by incorrect rolling.

Both Double-Nozzle Lances and Spray Guns are popular choices for use with this sprayer.



CENTRAL SPRAY UNIT

Hardi Kenya's involvement in the development of spraying technique within floriculture began in the 1980s, at the outset of the sector's growth. This experience has enabled Hardi to manufacture a Centralized System ideally suited to the farmers' needs. 1,350 and 2,300 litre clear PE chemical tanks are mounted on elevated stands, and fitted with high quality suction and return hoses, and brass hydrostatic agitators.

The 3-way operating unit is fitted above the suction, delivery and agitation exchange manifold. The pump, motor and control manifold are mounted on a sturdy base frame incorporating a pulley guard and hinged motor mounting providing easy access to the V- belts.

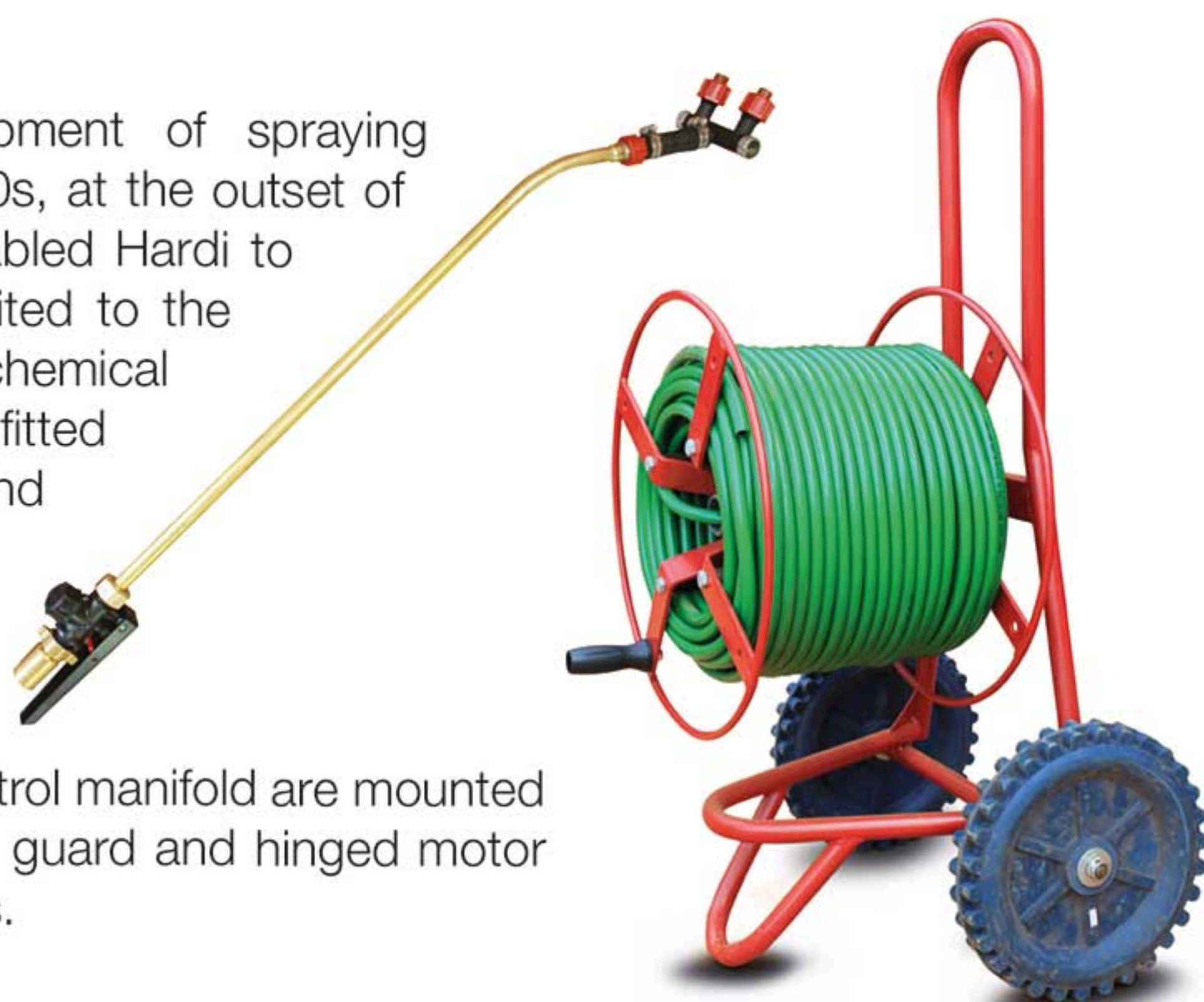

High pressure Comet and AR diaphragm and piston pumps, with specifications up to 130l/min at 50 bar are powered by 3-phase motors up to 10kW with separate star-delta starters complete with isolators.



Hardi Kenya's VARISPEED option, with its advanced automatic pressure regulating features, ensures instant pressure control and extended pump life.

Delivery hoses available include both PVC and high quality rubber pipes rated up at 80/200 bar, mounted on hose reel trolleys and fitted with double-ceramic nozzle spray lances.

HOCKEY STICK COFFEE SPRAYER

Hardi 1200 liter Hockey Stick Boom Sprayer

Built to withstand the rigours specific to coffee farming, Hardi's hockey stick boom coffee sprayer is based on a tried and tested design and uses the Comet IDS1000 brass-headed diaphragm pump. Fitted with two vertical booms made from heavy duty steel tubing and brass nozzle holders, it is designed to cope with the stresses of the conditions found on coffee farms. The COMET high pressure pump ensures correct coverage even when high spraying volumes are required. The Pressure Regulator is simple and easy to use. Options include horizontal Shielded Herbicide Booms and Hose Reels for use with hand-held Lances.

The sprayer frame is a narrow-gauge, heavy duty design, with a quick-turn drawbar. The 1,200 litre tank is made from rotationally moulded HDPE, which is strong, flexible and easy to repair. 750x16" wheels are mounted on purpose-built, heavy duty hubs with solid, tapered stub axles.

The Comet IDS1000 diaphragm pump, with its brass cylinder heads is known for its reliability and resistance to the corrosive effect of copper-based fungicides. Producing 100l/min at 50bar maximum pressure, it is ideal for the high volume application required for this form of spraying technique. The two Hockey Stick Booms are fitted with high volume brass fan jets with anti-drip valves.

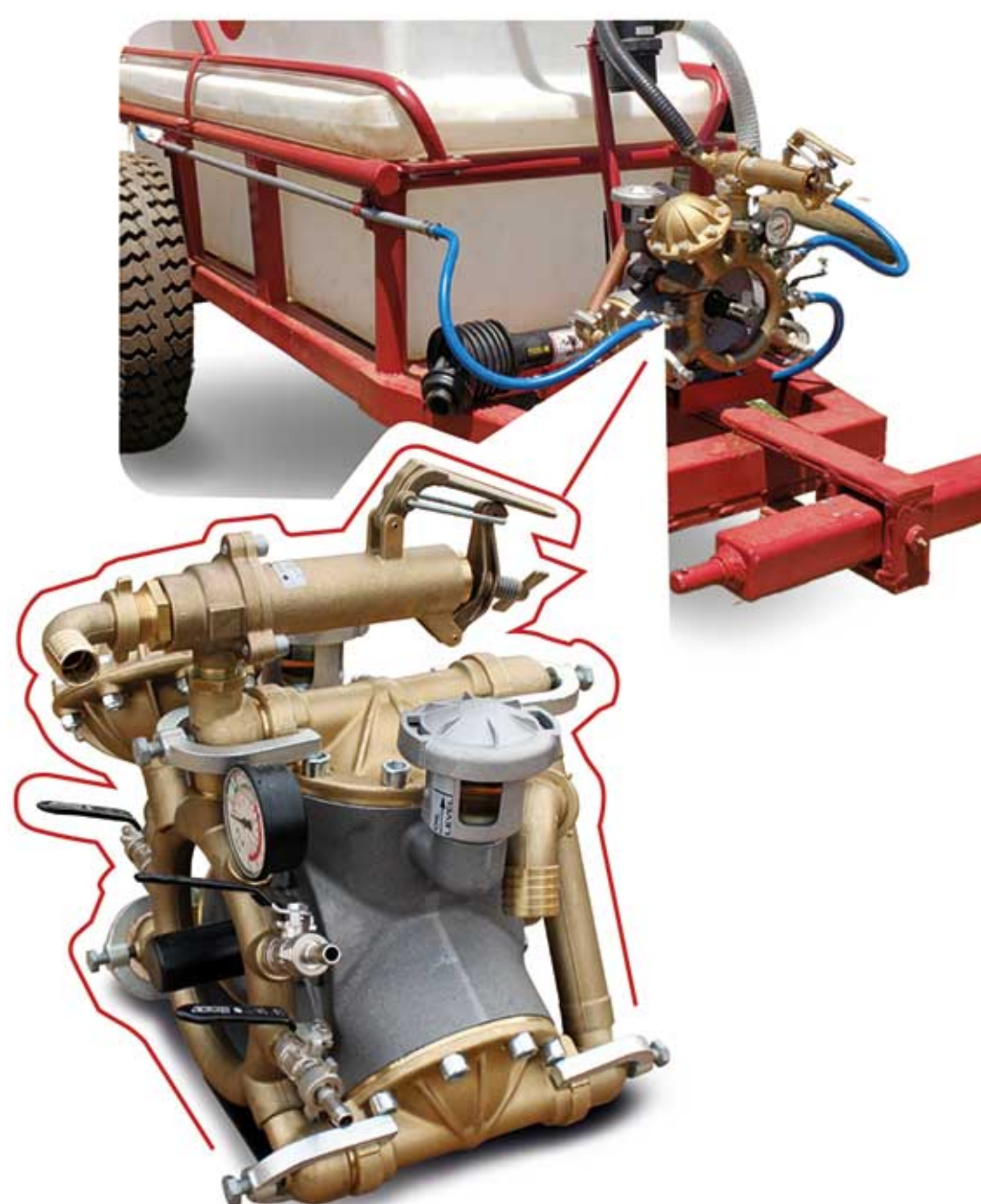

SPRAYING EQUIPMENT COMPONENTS



SPRAYING LANCES AND GUNS

1

DOUBLE NOZZLE SPRAY LANCE

c/w Trigger and Ceramic
Nozzle.

No: HKE - 846198



2

DOUBLE NOZZLE SPRAY LANCE

c/w Trigger and Ceramic
Nozzle.

No: HKE - 846198



3

DOUBLE NOZZLE SPRAY LANCE

c/w Trigger and Ceramic
Nozzle.

No: HKE - 846198

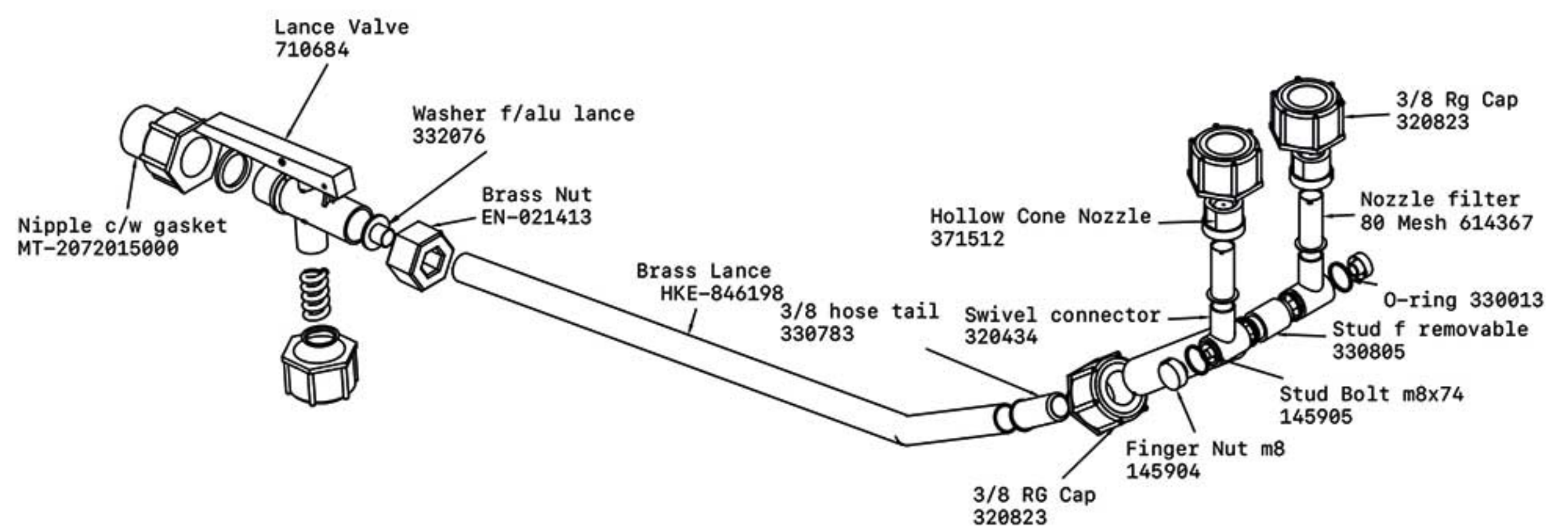

4

HYDRA SPRAY PISTOL

C/W 1.5 NOZZLE

No: SF - 5062400C



5

AL55 SPRAY LANCE

No: TM - 4022409000



6

LANCE VALVE



No: 710684

7

HAND SPRAY GUN 25 bar



No: HKE - 4010007001

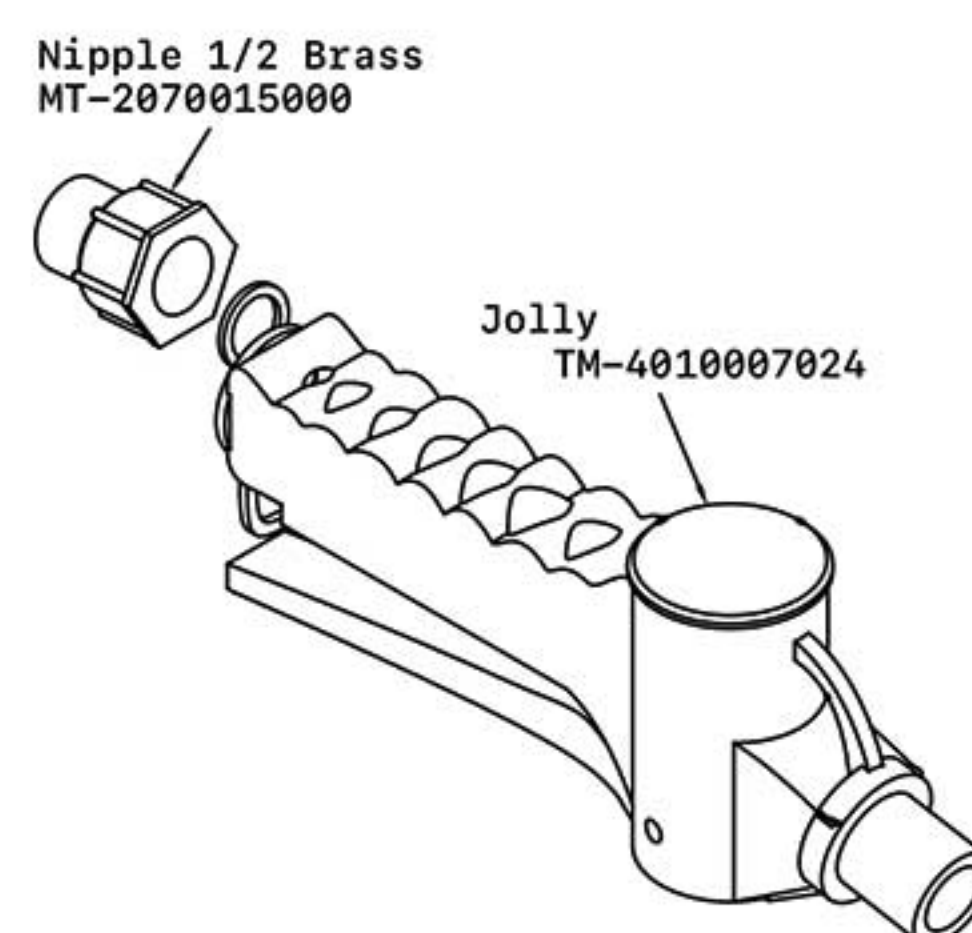

8

SPRAY GUN C/W BRASS NIPPLE



No: HKE - 5062600

1

LANCE VALVE**No: 710684**

2

LANCE VALVE**No: 710684**

3

LANCE VALVE**No: 710684**

4

LANCE VALVE**No: 710684**

5

LANCE VALVE**No: 710684**

SPRAYING
EQUIPMENT
COMPONENTS

6

LANCE VALVE



No: 710684

7

LANCE VALVE



No: 710684

8

LANCE VALVE



No: 710684

9

LANCE VALVE



No: 710684

10

LANCE VALVE



No: 710684

11

LANCE VALVE

No: 710684



12

LANCE VALVE

No: 710684

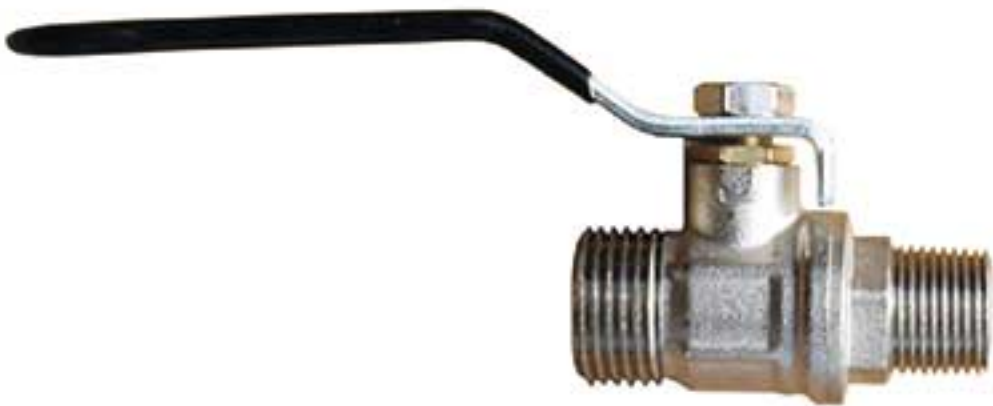

13

LANCE VALVE

No: 710684



14

LANCE VALVE

No: 710684



15

LANCE VALVE

No: 710684



16

LANCE VALVE



No: 710684

17

LANCE VALVE



No: 710684

18

LANCE VALVE



No: 710684

19

LANCE VALVE



No: 710684

20

LANCE VALVE



No: 710684



HARDI KENYA
CROP SPRAYING SPECIALISTS



HARDI KENYA LTD
CROP SPRAYING SPECIALISTS

Hardi Kenya Ltd,  Thika
P.O. Box 47409-00100 Nairobi, Kenya
 : 0733 754125 / 0707 268564  : sales@hardi.co.ke
 : www.hardi.co.ke  : [hardiKenya](https://www.facebook.com/hardiKenya)